

## LED Intelligent Driver

- Dimming interface: 0-10V(1-10V/10V PWM/RX), Push DIM
- Built-in SCM, dimming curve and smoothing time of power on can be customized.
- Dimming range from 0-100%, LED start at 0.1% possible.
- Automatic recognition of 0-10V, 1-10V input signal.
- 0-100% flicker-free, achieve the level of exemption assessment.
- Over-heat / Over voltage / Over load / Short circuit protection, recover automatically.
- Full protective plastic housing.
- Compliant with Safety Extra Low Voltage standard.
- Suitable for indoor I / II/III type lamps application.



**Flicker-free**

IEEE 1789  
Achieve the exemption level.

**Dimmable:**  
0.1%-100%

**5 in 1 dimming**

0-10V  
1-10V  
10V PWM  
RX  
Push DIM



### Specification

Model	LM-75-12-G1A2	LM-75-24-G1A2	LM-100-24-G1A2	
<b>OUTPUT</b>	Output Voltage	12Vdc	24Vdc	
	Output Voltage Range	12Vdc ±0.5Vdc	24Vdc ±0.5Vdc	
	Output Current	Max. 6.25A	Max. 3.125A	Max. 4.17A
	Output Power	Max. 75W		Max. 100W
	Output Power Range	0~75W		0~100W
	Strobe Level	High frequency exemption level.		
	Dimming Range	0~100%, dimming depth: Max. 0.1%		
	Overload Power Limitation	≥ 102%		
	Ripple & Noise	≤ 200mV	≤ 300mV	
PWM Frequency	≤ 3600Hz			
<b>INPUT</b>	Dimming Interface	0-10V(1-10V/10V PWM/RX), Push DIM		
	Input Voltage	220-240Vac		
	Frequency	50/60Hz		
	Input Current	Max. 0.4A/230Vac	Max. 0.5A/230Vac	
	Power Factor	PF>0.97/230Vac, at full load	PF>0.98/230Vac, at full load	
	THD	≤ 14% at 230Vac, at full load	≤ 12% at 230Vac, at full load	
	Efficiency [typ.]	91%	92%	93%
	Inrush Current[typ.]	Cold start 30A at 230Vac	Cold start 45A at 230Vac	
	Control surge capability	L-N:2KV		
Leakage Current	Max. 0.5mA			
<b>ENVIRONMENT</b>	Working Temperature	ta: -20°C ~ 50°C tc: 80°C		
	Working Humidity	20 ~ 95%RH, non-condensing		
	Storage Temp., Humidity	-40°C ~ 80°C, 10-95%RH		
	Temp. Coefficient	±0.03%/°C (0-50°C)		
	Vibration	10-500Hz, 2G 12min./1cycle, period for 72min. each along X, Y, Z axes.		
<b>PROTECTION</b>	Over-heat Protection	Intelligently adjusting or turning off the output current if the PCB temperature ≥ 110°C, auto recovers.		
	Over Voltage Protection	Shut down the output when non-load voltage ≥ 13V, re-power on to recover after fault condition is removed.	Shut down the output when non-load voltage ≥ 26V, re-power on to recover after fault condition is removed.	
	Over Load Protection	Shut down the output when current load ≥ 102%, auto recovers.		
	Short Circuit Protection	Shut down automatically if short circuit occurs, auto recovers.		
<b>SAFETY &amp; EMC</b>	Withstand Voltage	I/P-O/P: 3750Vac		
	Isolation Resistance	I/P-O/P: 100MΩ/500VDC/25°C/70%RH		
	Safety Standards	IEC/EN61347-1, IEC/EN61347-2-13		
	EMC Emission	EN55015, EN61000-3-2 Class C, IEC61000-3-3		
	EMC Immunity	EN61000-4-2,3,4,5,6,8,11 EN61547		
	Strobe Test Standard	IEEE 1789		
<b>OTHERS</b>	Dimension	293×43×30mm(L×W×H)		
	Packing	296×44×33mm(L×W×H)		
	Weight(G.W.)	300g±10g		

\* The driver is suitable for connecting resistor current-limiting LED fixture (e.g. LED strip). The instantaneous surge current will be several times increased if connecting built-in constant current IC current-limiting LED fixtures, the driver will activate the overloaded protection (hiccup flickering). When you order, please remark controlling the constant current LED fixture (e.g. MR16 lamp, underground light, LED wall washer, constant current LED strip, etc.), then we can prepare the special programs.

### Dimensions

Unit: mm

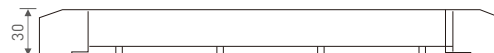
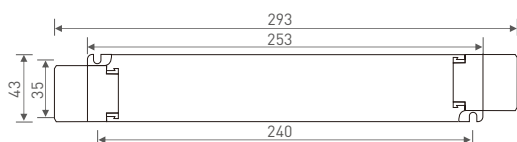

## Wiring Diagram



## Application of Protective Cover

Wire pressing board:

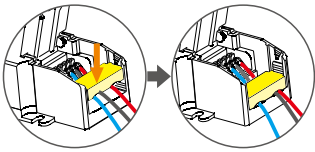

Push the wire pressing board to fix the wire.

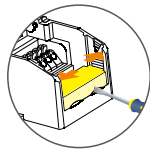

Push outward the side plate, meanwhile use the tool to uninstall the wire pressing board.

Uninstall protective cover:

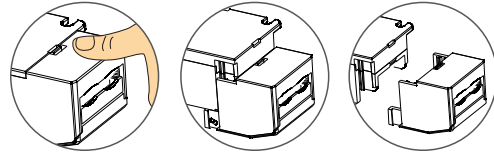

Break off the bottom left and right to remove the protective cover.

## Push Dimming



Reset switch

- On/off control: Short press.
- Stepless dimming: Long press.
- With every other long press, the light level goes to the opposite direction.
- Dimming memory: Brightness will be the same as previously adjusted when turning off and on again.

## Relationship Diagrams

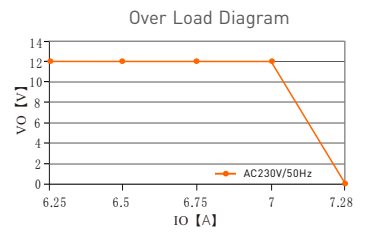
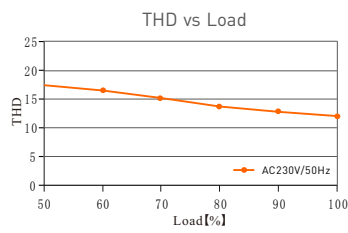
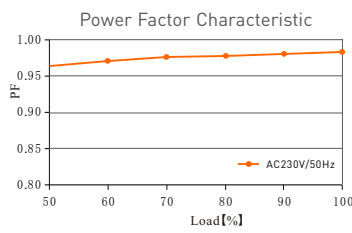
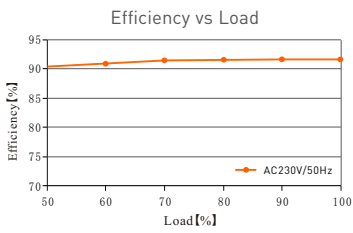

LM-75-12-G1A2

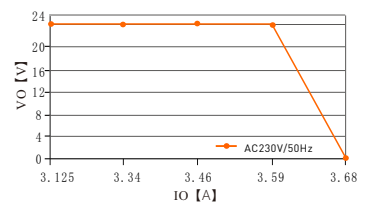
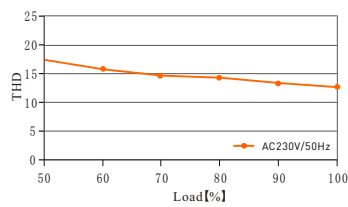
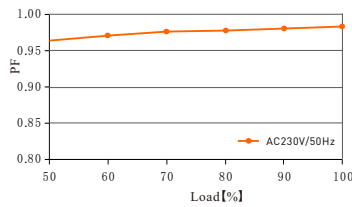
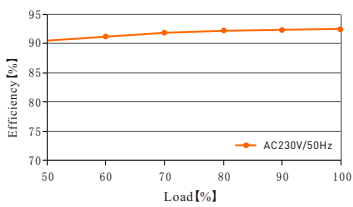

LM-75-24-G1A2

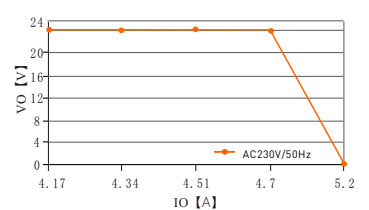
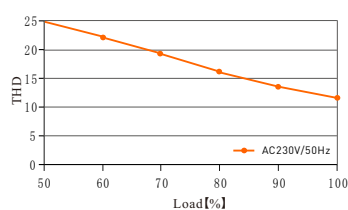
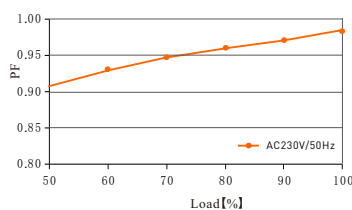
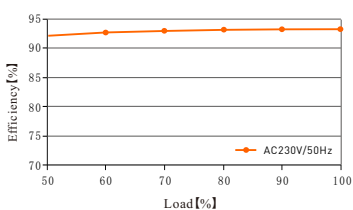

LM-100-24-G1A2